

Albuquerque

4000 Menaul Blvd. NE



 Demographics	1 Mile	3 mile	5 mile
Population	14,591	115,378	292,117
Med. Income	\$45,293	\$43,496	\$47,047
Day Population	13,436	103,154	249,362

Please contact us for leasing opportunities

Available

- Commercial Space
- 2528 Morningside | 975 SF | \$1,500/Month

Surroundings Info

- Excellent location in the Uptown area.
- Prominent signage along Menaul.
- Easy access to and from I-40.
- Locally owned and managed.



Contact

 Brighton Pope
 505.884.3578
 Brighton.Pope@PetersonProperties.net

 PetersonProperties.net
 /petersonpropertiesllc
 /petersonpropertiesllc
 /peterson.properties



Site Plan

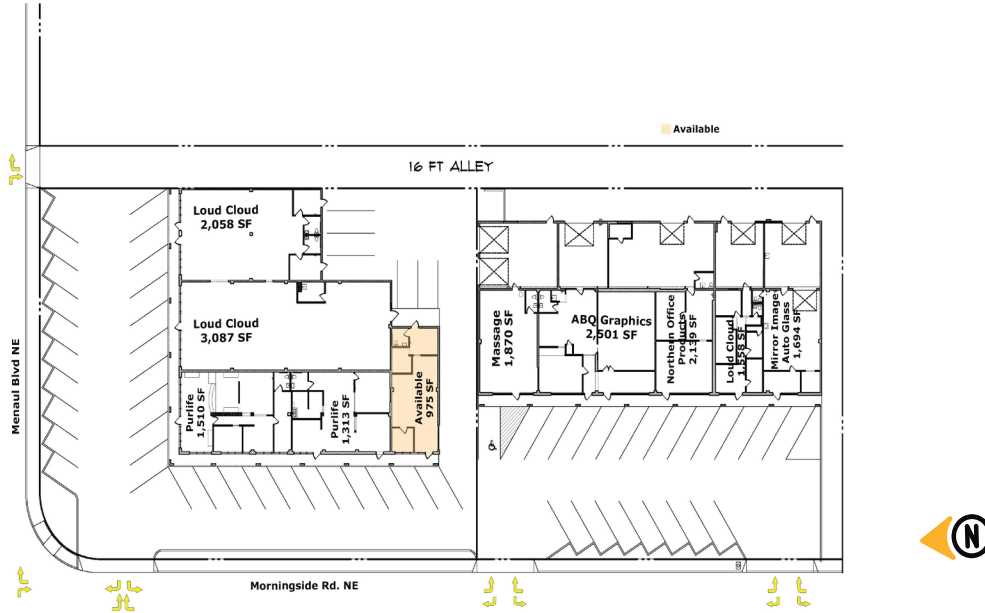

Please contact us for leasing opportunities



Aerial Map



4000 Menaul Blvd. NE Albuquerque, NM 87110

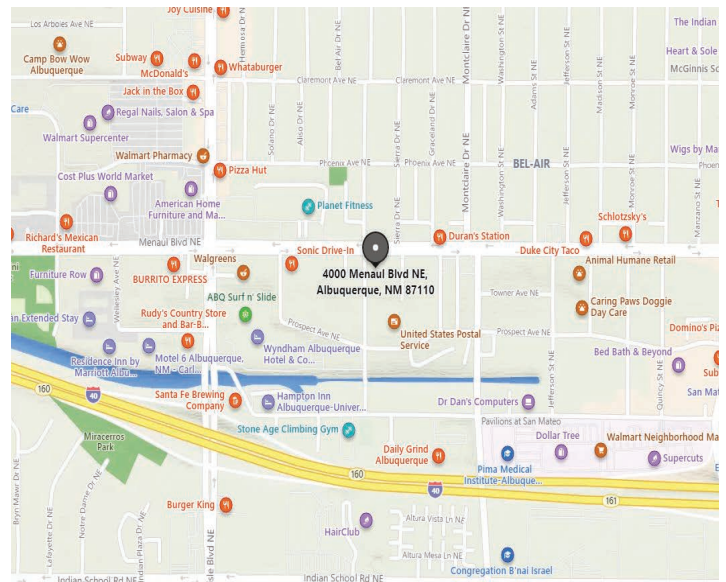
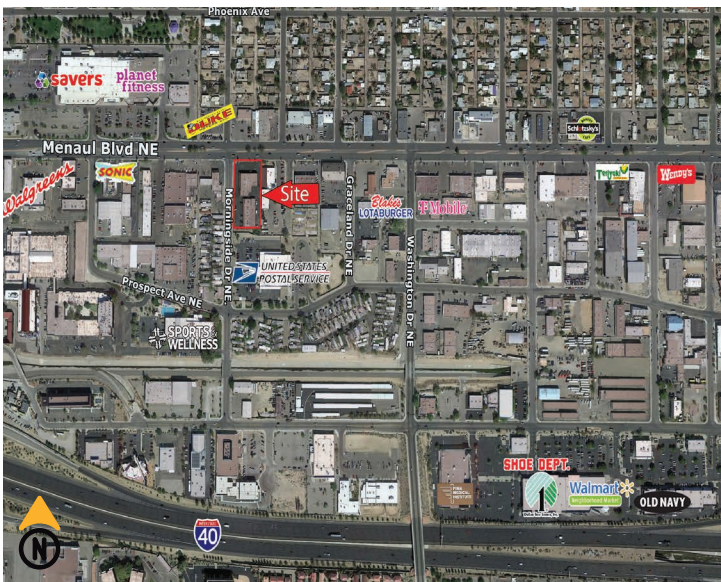

Contact us



 Brighton Pope

 505.884.3578

 Brighton.Pope@PetersonProperties.net

