

Albuquerque, NM - Downtown
616 Lomas Blvd. NW



 Available

- 100% occupied



Huge Surrounding Population



Dedicated Parking



Active Nightlife Area



HUB Zone qualified location

Please contact us for leasing opportunities

 Demographics

1 Mile

3 mile

5 mile



Population	11,744	95,933	248,161
Med. Income	\$32,618	\$36,143	\$38,616
Day Population	53,394	119,493	221,812

 Surroundings Info

- Close to Courthouses & City Hall.
- Prominent Freestanding Sign on Lomas.
- Convenient Access.
- Locally owned and managed.



Contact

 Vanessa Valadez
 505.884.3578
 Vanessa@PetersonProperties.net

 PetersonProperties.net
 /petersonpropertiesllc
 /petersonpropertiesllc
 /peterson.properties



Site Plan

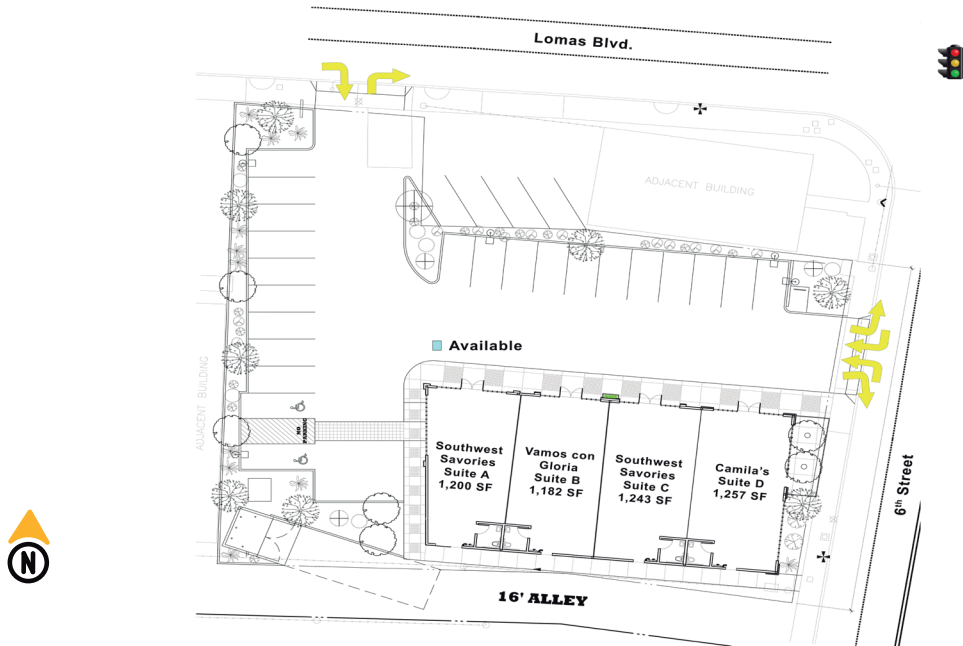

Please contact us for leasing opportunities



Aerial Map

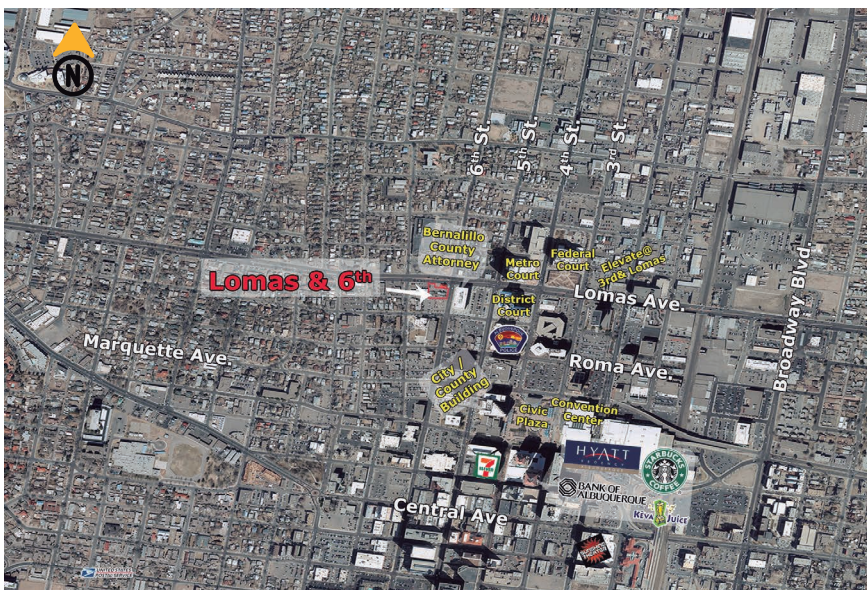

Southwest corner of Lomas Blvd. & 6th St. Albuquerque, NM

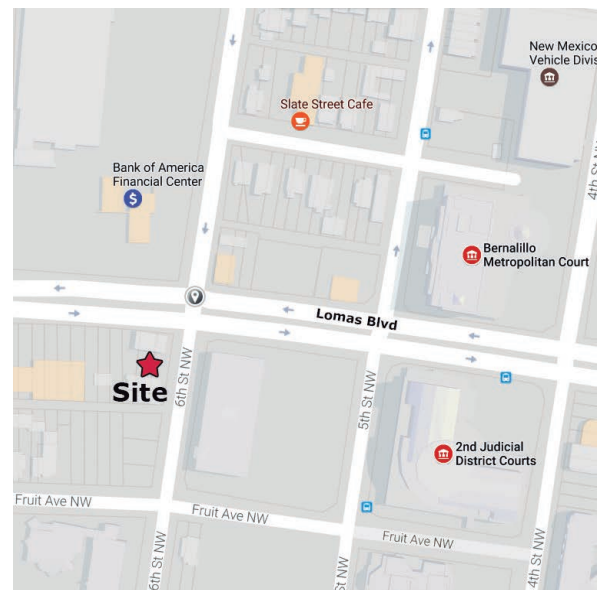

Contact us



Vanessa Valadez

505.884.3578

Vanessa@PetersonProperties.net

