



2920 Carlisle NE

Commercial Spaces

Albuquerque's Northeast Heights 2920 Carlisle Blvd. NE



 Demographics	1 Mile	3 mile	5 mile
Population	13,424	103,755	286,306
Med. Income	\$55,502	\$60,636	\$63,095
Day Population	13,552	135,785	263,782

Please contact us for leasing opportunities

Available

- Office, Service + Retail Spaces
- Suite A6 | 150 SF | \$275/Month
- Suite A7 | 200 SF | \$350/Month

Features

- Single Story Buildings.
- Excellent signage visibility.
- Easy access to I-40 & I-25.
- Free Wi-Fi (excluding Bldg. B) & Secured Entry.
- Locally owned and managed.



Contact

 Brighton Pope
 505.884.3578
 Brighton.Pope@PetersonProperties.net

 PetersonProperties.net
 /petersonpropertiesllc
 /petersonpropertiesllc
 /peterson.properties

 Site Plan

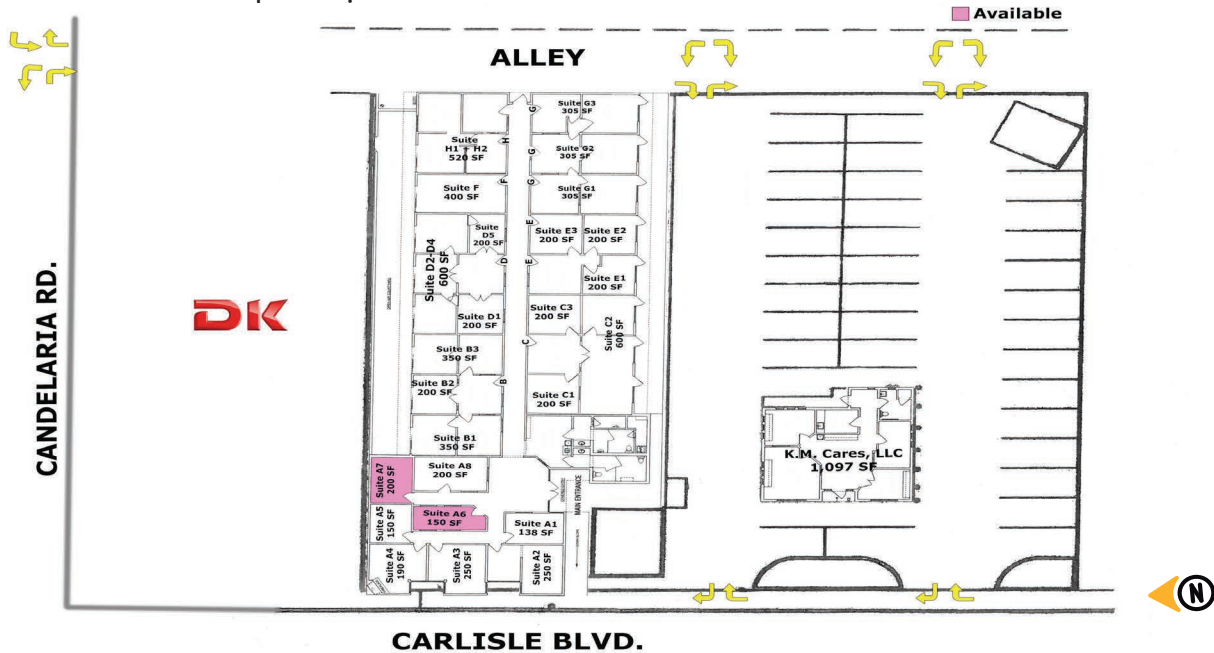

 Aerial Map

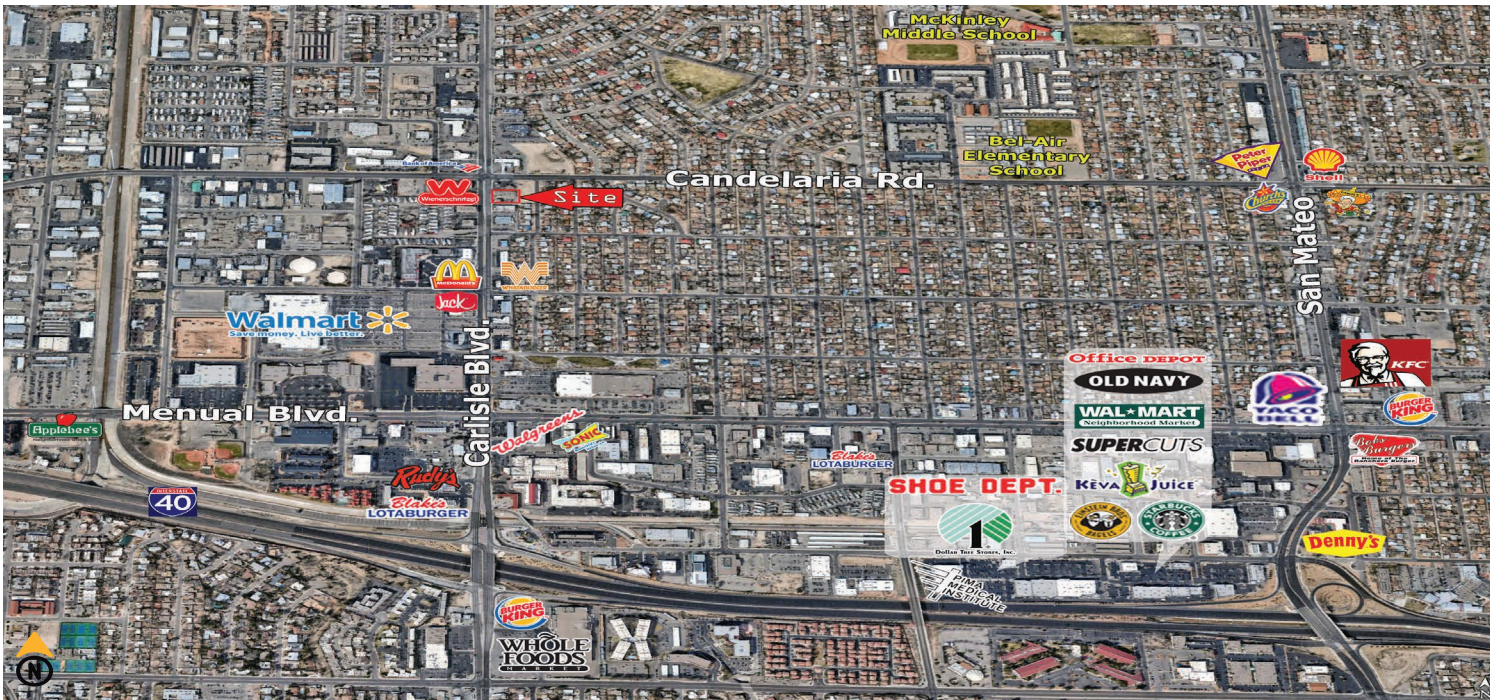

Contact us

 Brighton Pope |  505.884.3578 |  Brighton.Pope@PetersonProperties.net

