

Albuquerque

7710 Menaul Blvd. NE



 Demographics	1 Mile	3 mile	5 mile
Population	13,662	148,889	318,784
Med. Income	\$45,489	\$41,296	\$43,655
Day Population	15,005	88,770	234,281

Please contact us for leasing opportunities

Available

- Suite B | 458 SF | \$995/Month

Surroundings Info

- In the heart of Uptown retail & offices.
- Locally owned & managed.
- Excellent visibility of storefront.
- Large traffic flow on Menaul Blvd.



Contact

-  Brighton Pope
-  505.884.3578
-  Brighton.Pope@PetersonProperties.net

-  PetersonProperties.net
-  [/petersonpropertiesllc](https://www.facebook.com/petersonpropertiesllc)
-  [/petersonpropertiesllc](https://www.linkedin.com/company/petersonpropertiesllc)
-  [/peterson.properties](https://www.instagram.com/peterson.properties)



Site Plan

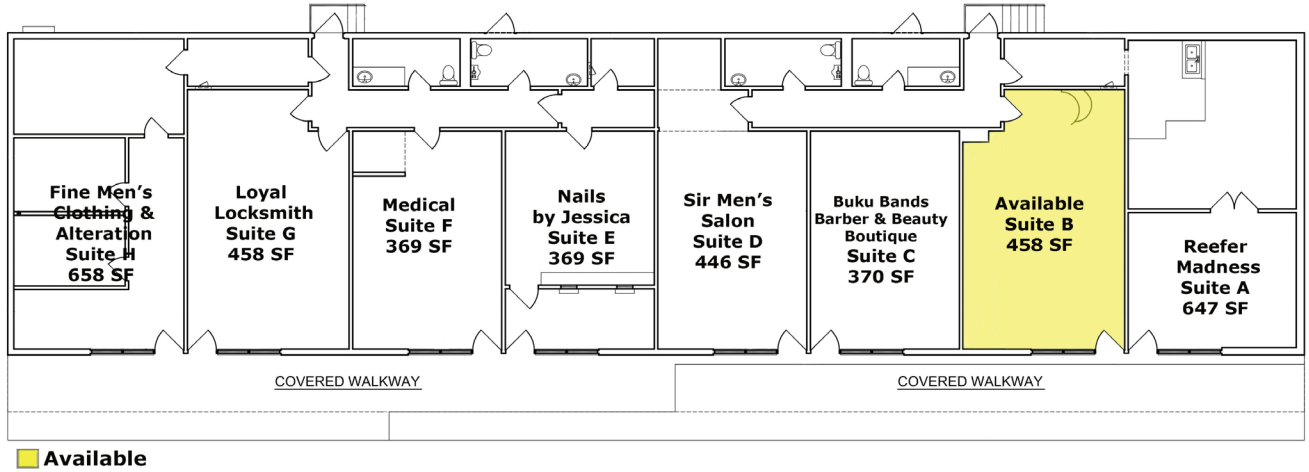

■ Available



Please contact us for leasing opportunities



Aerial Map



7710 Menaul Blvd. NE Albuquerque, NM 87110

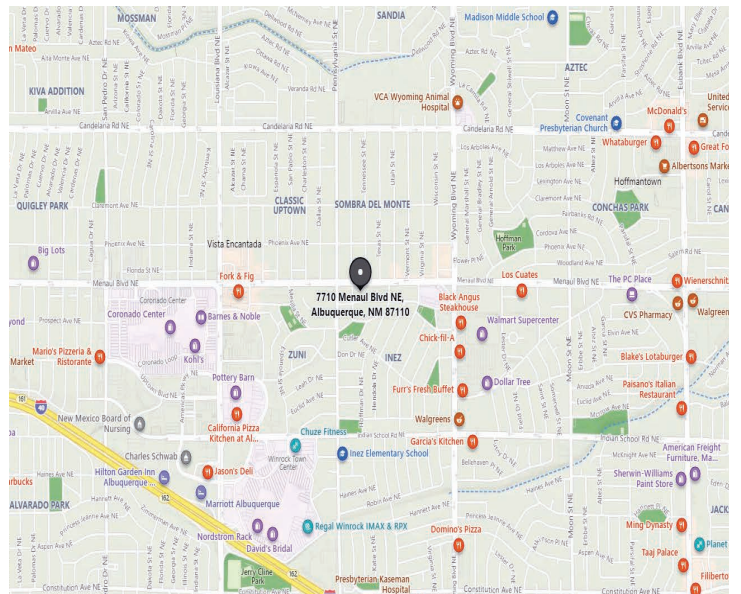

 Brighton Pope

 505.884.3578

 Brighton.Pope@PetersonProperties.net

