

Albuquerque, NM - Downtown
616 Lomas Blvd. NW



 Available

- Suite A | 1,200 SF
\$2,400/Month



Huge Surrounding
Population



Dedicated
Parking



Active Nightlife
Area



HUB Zone
qualified location

Please contact us for leasing opportunities

 Demographics

1 Mile

3 mile

5 mile

Population	11,744	95,933	248,161
Med. Income	\$32,618	\$36,143	\$38,616
Day Population	53,394	119,493	221,812

 Surroundings Info

- Close to Courthouses & City Hall.
- Prominent Freestanding Sign on Lomas.
- Convenient Access.
- Locally owned and managed.



Contact

- Vanessa Valadez
- 505.884.3578
- Vanessa@PetersonProperties.net

- PetersonProperties.net
- [/petersonpropertiesllc](https://www.facebook.com/petersonpropertiesllc)
- [/petersonpropertiesllc](https://www.instagram.com/petersonpropertiesllc)
- [/peterson.properties](https://www.linkedin.com/company/petersonproperties)



Site Plan

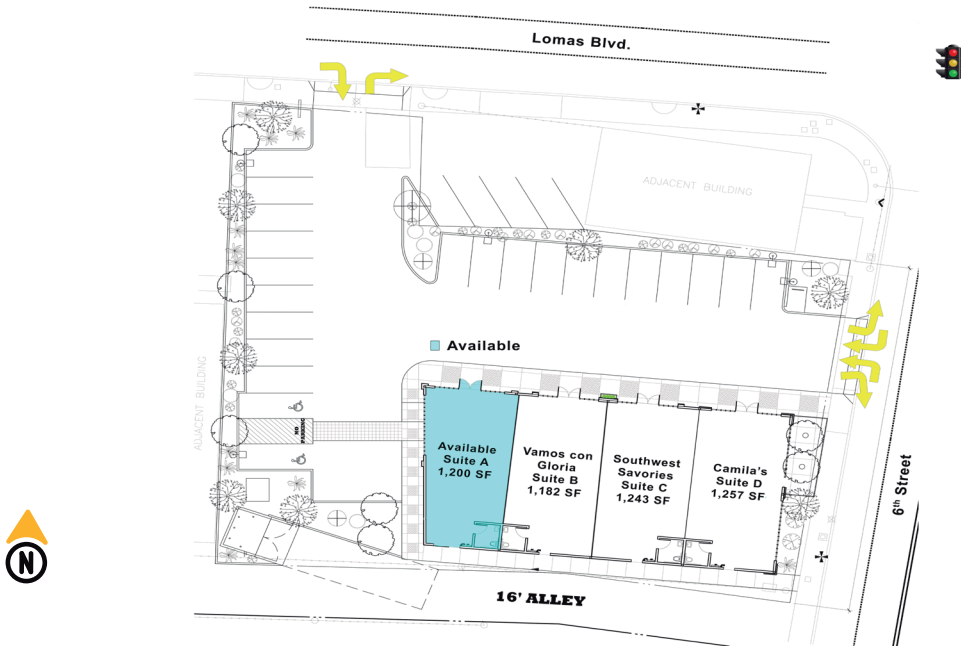

Please contact us for leasing opportunities



Aerial Map

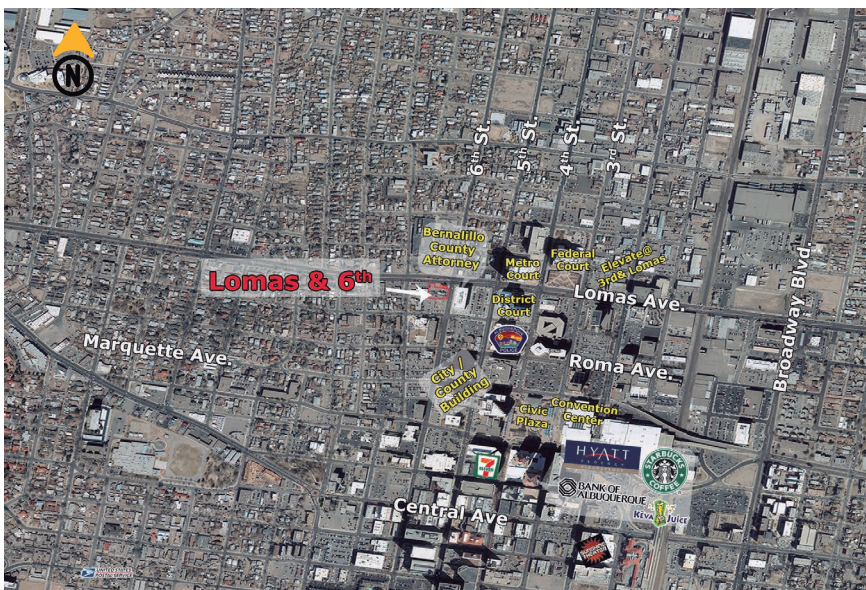

Southwest corner of Lomas Blvd. & 6th St. Albuquerque, NM

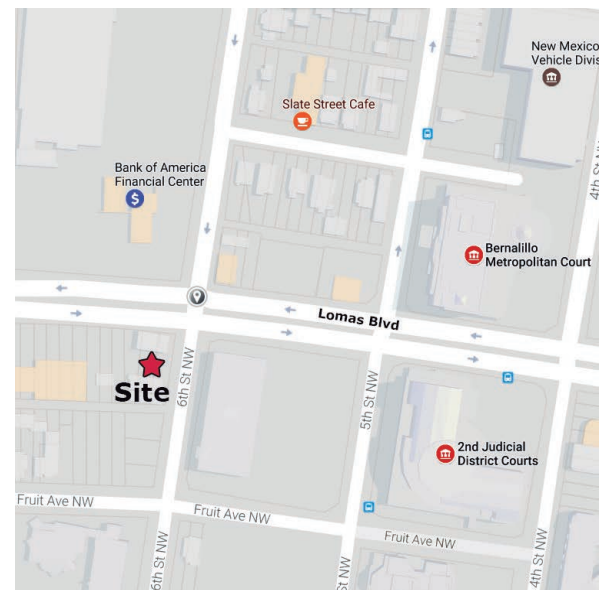

Contact us



Vanessa Valadez

505.884.3578

Vanessa@PetersonProperties.net

